

2012 CATALOG
ENGINEERING A BETTER COMMUNITY

GMC YUKON

SCULPTURE
IN THE PARK

WILD HORSE
SANCTUARY

QUAD RUGBY
TRAINING



YUKON DENALI HYBRID IN WHITE DIAMOND TRICOAT

Only professional-grade engineering can give you a full-size SUV and best-in-class fuel economy of 20 city/23 hwy mpg.¹



REAL LIFE. REAL PROJECTS. Making a real difference. GMC vehicles aren't made to sit in the showroom. They're designed, engineered and built to get things done, to defy the impossible and to never say the job is over until you've overachieved. This is why GMC has joined with the people and organizations you're about to meet. People who are making a difference in their communities and effecting real change. From advancing the arts to providing safe haven to an American icon or helping disabled athletes pursue their dreams, GMC is proud to present these stories of what can really happen in life when you never say never.

GMC. WE ARE PROFESSIONAL GRADE.



TABLE OF CONTENTS

2 - 19

PART 1

GMC COMMUNITY PROJECTS

- SCULPTURE IN THE PARK, 2
- WILD HORSE SANCTUARY, 12
- QUAD RUGBY TRAINING, 16

Learn about the organizations and individuals GMC is partnering with who are committing their innovative spirit and uncompromising attitude to projects that make a long-lasting impact on their communities.

20 - 23

PART 2

FEATURES AND THEIR BENEFITS

The what, the where and the how of professional-grade engineering. It's everything you need to know about the 2012 GMC Yukon, from the 9600 pounds of maximum trailering capacity² of Yukon XL ¾-ton to the Hybrid's EPA-estimated 20 mpg city.

24 - 29

PART 3

SPEC YOUR MODEL

Compare all the options, check out the accessories and customize your own 2012 GMC Yukon.

QR CODES

HOW TO SCAN A QR CODE

Use your smartphone to scan the QR codes shown throughout the catalog. After scanning the code, your smartphone will be directed to a mobile site for more information on each project. If you do not have a QR code reader, simply download a free reader through the app store on your smartphone device.

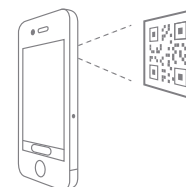

HOW TO USE THE URL IF YOU DON'T HAVE A SMARTPHONE

If you don't have a smartphone, you can still experience all the extra content by logging on to the Web and entering the Web address found next to the QR code.

¹EPA estimated. 2011 GM Large Utility segment. ²Maximum trailer weight ratings are calculated assuming a base vehicle, except for any option(s) necessary to achieve the rating, plus driver. The weight of other optional equipment, passengers and cargo will reduce the maximum trailer weight your vehicle can tow. See your GMC dealer for additional details. Vehicle shown with available equipment.

PROJECT
SCULPTURE IN THE PARK—BROOKLYN, NY

THE ART OF UNCOMPROMISING ART.

Like the nature that inspires him, Robert Lobe believes the definition of art can't be restrained. It can't be confined to a canvas or seen only in a museum. To Lobe, the thought of art, the idea of art, is bigger than a gallery or an exhibition. Art happens every day, and it happens all around us.

So he set out to put art where the people are.

A New York City-based artist and sculptor, Lobe uses items like rocks and tree limbs to shape sculptures that highlight the random beauty of life itself. Although his work has been displayed around the world, for his latest series, "Nature in Nature," he wanted to bring it a little closer to home, namely Brooklyn's own Prospect Park. But how do you move half-ton sculptures from the studio to the park? You start by never saying never. With GMC's help, Lobe had the power to haul his three sculptures to the site, the capability to navigate works of art through the hustle of the city and the bold thinking to see the project through to completion.

BUT WHAT CAN THE IDEA OF PUBLIC ART SAY ABOUT THE THINKING BEHIND THE GMC YUKON?

It says that true inspiration always makes an impact and great ideas should never be confined by convention. Which is why Yukon XL offers something no other competitor can: a $\frac{3}{4}$ -ton model that can tow a best-in-class maximum trailer weight rating of up to 9600 lbs.¹ It says that compromise should never have a place in art or engineering, as proven by Yukon's impressive flexibility, complete with seating configurations that can accommodate seven, eight or nine passengers. And it makes it all the more obvious that with professional grade, even everyday life can be like a work of art. **GMC YUKON.**



FOR MORE OF THE STORY, SCAN THE QR CODE WITH YOUR
SMARTPHONE OR VISIT GMC.COM/YUKON_SCULPTURE



YUKON DENALI HYBRID IN WHITE DIAMOND TRICOAT
Standard 22" chrome wheels, distinctive badging and GMC's signature bold design make Yukon Denali Hybrid a smart and stylish ride.



↓ Yukon Denali Hybrid's analog gauge cluster keeps you up to date and in control of your vehicle's speed, mileage, fuel levels and more.

↓ Fingertip controls on the steering wheel give you convenient access to your radio, volume and Bluetooth® capability.¹



¹Go to gm.com/bluetooth to find out which Bluetooth phones are compatible with the vehicle.



↑ The unique appointments of Denali's beautifully crafted interior combine attention to detail with a practical, organized layout.

↓ All Yukon Denali models come standard with soft Nuance leather-appointed seating for a beautiful and durable interior.

↓ Your comfort is guaranteed with Denali's standard 12-way power heated and cooled front seats, easily adjusted with fingertip controls.







YUKON XL SLT IN QUICKSILVER METALLIC
Coil-over-shock independent front suspension stabilizes the rough spots and tight corners for a stable, more responsive ride.





YUKON SLT IN QUICKSILVER METALLIC The available power liftgate can be opened and closed with a touch of a button, making Yukon's cargo capacity not only impressive but easy to use.



↑ Available Rear-Vision Camera System displayed either in the rearview mirror, or when ordered, the navigation screen, helps make things like hitching your trailer that much easier.



↑ The available touch-screen navigation¹ comes with CD/DVD capability and provides real-time mapping so your trip can stay on track.

↓ **YUKON SLT INTERIOR IN LIGHT TITANIUM** Leather-wrapped steering wheel, easy-to-use Driver Information Center and available NAV radio with a hard drive that can store up to 30 GB of music are just some examples of what makes Yukon's interior a refined and inviting space.



THE TALENT BEHIND SCULPTURE IN THE PARK

GMC YUKON

Robert Lobe's "Nature in Nature" exhibition is three separate sculptures that have been installed in Brooklyn's Prospect Park. Lobe, a sculptor whose work has appeared around the world, created "Nature's Clock," "Invisible Earth" and "Antique Jenny" for specific sites on the grounds of the park's historic boathouse, to be enjoyed by the public in a natural setting.



↓ Assistant Keegan Stephan helps assemble a sculpture during the installation.

↑ Robert Lobe at the site of his art installation in Prospect Park, Brooklyn.

↓↓ Assistants wait for final instructions from Lobe.

↓ "Invisible Earth" is moved into position in the water facing the historic boathouse.



↓ Unloading tools and materials for the sculptures' installations.

↓ Robert Lobe putting the final touches on "Antique Jenny."

↓ Lobe makes some final measurements for the footing of "Nature's Clock."



 To join the conversation about these projects, or to learn how people are making a difference, visit facebook.com/gmc and look for "Community Projects."

PROJECT
WILD HORSE SANCTUARY—LOMPOC, CA

THE BIGGEST JOBS DEMAND BOLDER THINKING.

There's an American symbol that's about to disappear.

After years of eroding habitat and destructive policies, the wild horses of the western landscape are rapidly fading away. But nestled in California's Jalama Valley is a place that refuses to let that happen. It's a place that says never say never.

The Return to Freedom Sanctuary has rescued over 1000 wild horses and burros, preserving entire herd groups. The animals have room to roam and run free, and genetic bloodlines are kept intact. With GMC's help, Return to Freedom was able to complete much needed maintenance and improvements to the ranch's land and infrastructure, providing a safer and more secure environment and helping advance the mission of the sanctuary itself: to protect the freedom, diversity and habitat of America's wild horses for generations to come.

IT'S A BIG JOB, BUT THEY KNOW THEY'RE UP FOR THE CHALLENGE. GMC YUKON WAS BUILT WITH THAT SAME CONFIDENCE.

The benchmark of full-size SUVs, Yukon was engineered to excel. Yukon Denali's 403 hp and 417 lb-ft of torque lead its class in both categories. Yukon XL Denali can boast of more cargo capacity¹ behind the first-, second- and third-row seats than any competitor in its class. And with Yukon Hybrid, GMC gave America its first full-size SUV hybrid. It's big thinking for a bolder future. It's conservation without compromise. It's what brings the great minds of GMC together. And what separates Yukon from everything else. **GMC YUKON.**



FOR MORE OF THE STORY, SCAN THE QR CODE WITH YOUR
SMARTPHONE OR VISIT [GMC.COM/YUKON_SANCTUARY](https://www.gmc.com/yukon_sanctuary)



YUKON DENALI HYBRID IN ONYX BLACK Professional-grade engineering gives you up to 66 percent better city mpg² than any other full-size SUV in its class, while still retaining the impressive presence you expect from Yukon.

¹Cargo and load capacity limited by weight and distribution. ²EPA-est. 20 mpg. Based on 2011 GM Large Utility segment. Vehicle shown with available equipment.



↓ **YUKON DENALI HYBRID IN ONYX BLACK** With an EPA-estimated 20 city/23 hwy mpg, plus a maximum trailering capacity of 6000 lbs,¹ Denali gives you conservation without compromise.

↑ Wild horses from the Calico Mountain Complex public lands are one of the natural herd groups Return to Freedom has successfully rescued.



¹Maximum trailer weight ratings are calculated assuming a base vehicle, except for any option(s) necessary to achieve the rating, plus driver. The weight of other optional equipment, passengers and cargo will reduce the maximum trailer weight your vehicle can tow. See your GMC dealer for additional details.

THE STORY BEHIND RETURN TO FREEDOM

GMC YUKON

Return to Freedom is a nonprofit wild horse sanctuary founded in 1997 by Neda DeMayo. The realization of her life-long dream, the sanctuary's mission is to protect the freedom, diversity and natural lifestyle of America's free-range wild horses, becoming the first sanctuary to focus on rescuing entire family bands of wild horses.



↓ Peter Wright checks to make sure a horse is stable in the "squeeze chute," the machine used to rotate the animal for easier and safer hoof trimming.

↑ Neda DeMayo, Founder of Return to Freedom; Aaron Thayne, natural hoof care practitioner; Albert Villasevil Florensa, veterinarian; Daniel Reader, Association for the Advancement of Natural Horse Care Practices—Apprentice and Peter Wright, Return to Freedom Ranch Manager, planning the next round of vaccinations and hoof trimming at the wild horse holding facility in Fallon, NV.



↑ A GMC Yukon travels through California's beautiful Jalama Valley, home to Return to Freedom.

↑ DeMayo and her team consider educating the public to be one of the sanctuary's main missions, offering youth programs, retreats and clinics throughout the year.

↓ Florensa (left) and Thayne trimming hooves at the Fallon Cattle and Feed facility in Fallon, NV.

↓ Thayne and Florensa demonstrate the natural way to clean a horse's hoof.

↓ Two trucks prepare for morning hay feed.



 To join the conversation about these projects, or to learn how people are making a difference, visit facebook.com/gmc and look for "Community Projects."

PROJECT
QUAD RUGBY TRAINING—AUSTIN, TX

LIFE IS ABOUT MORE THAN LIMITATIONS.

Big thinking. Bigger dreams. And the passion to prove that those who say you can't are wrong.

The men and women of Team Force Quad Rugby live life never saying never.

Playing a sport that some would say is beyond them, Team Force makes believers out of anyone who watches them. With drive, determination and perseverance, they pursue a goal most fully functioning athletes can't even dream of: representing their country on the stage of international play. But with logistics and capability an issue, how to make that dream a reality? They relied on the help of GMC, traveling over 700 miles from Austin to Alabama to reach the national tryouts. Proving that big obstacles can always be brought down to size if you have the right attitude. Because like the engineering behind GMC, the players know if you dream big, you'll find you build your life for better things.

THAT'S THE SAME IDEA WE BUILD INTO EVERY GMC YUKON.

Engineered to be as capable as it is refined, Yukon is the uncompromising choice in full-size SUVs. Never limited by small thinking, Yukon's Vortec V-8 engine family delivers power without concession, giving Yukon Denali the most power in its class and making Yukon Hybrid the first full-size SUV with a two-mode hybrid system that offers the best fuel economy in its class.¹ And with Yukon XL offering cargo room unmatched by any competitor and seating for up to nine, capacity never takes a backseat to efficiency. No compromise. No excuses. It's what makes Yukon like no other SUV out there. **GMC YUKON.**



FOR MORE OF THE STORY, SCAN THE QR CODE WITH YOUR
SMARTPHONE OR VISIT GMC.COM/YUKON_RUGBY





YUKON SLT IN QUICKSILVER METALLIC With an EPA-estimated 15 city/21 hwy mpg, Yukon has better fuel economy than any other competitor.



↑ **YUKON SLT INTERIOR IN LIGHT TITANIUM** With standard second-row bench seats or optional captain's chairs plus standard three-passenger split-bench third row, Yukon gives you many flexible options for seating. An available Rear-Seat Entertainment System with an 8" diagonal LCD screen provides plenty of entertainment for second-row passengers.

↓ The available leather-appointed seating in Yukon's first two rows, plus amenities like generous center storage and a nine-speaker Bose® sound system, make any trip a luxury cruise.



THE ATHLETES OF TEAM FORCE QUAD RUGBY

GMC YUKON

Team Force Quad Rugby pulls the best athletes from wheelchair rugby teams around the country for a chance to test their skills against the highest level of competition. With 13 members and an 8-month season, the team serves as a valuable training ground for the national team, advancing 10 players in their 6 years of existence.



↓ The Quad Rugby Coach, James Gumbert, aka "Coach Gumbie:"

↓ Players have a warm-up game in Austin, TX.

↑ Team Manager Carolyn Boebinger enjoys some downtime with player Jeff Butler.



↑ A player wraps his hands with tape before practice.

↓ Player C.J. Brown using his "tire-dragging" technique for training.

↓ Quad Rugby is played with a volleyball.

↓ Boebinger and Butler unload equipment.



Facebook icon: To join the conversation about these projects, or to learn how people are making a difference, visit facebook.com/gmc and look for "Community Projects."

Vehicles shown with available equipment.

POWERTRAINS

ENGINES

For uncompromised power and torque and unparalleled refinement, look no further than the Vortec engine family. Each model uses innovative “vortex technology” to swirl and tumble the incoming air and fuel for optimum power and response.

VORTEC 5.3L V-8 VVT (LMG)/(LC9)

Active Fuel Management / FlexFuel Capable

HORSEPOWER: 320 hp @ 5400 rpm
TORQUE: 335 lb-ft @ 4000 rpm

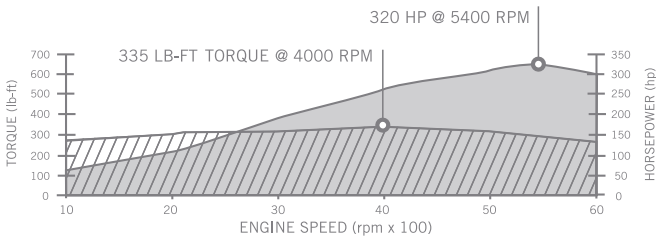

VORTEC 6.0L V-8 VVT (L96)

¾-ton Models Only

HORSEPOWER: 352 hp @ 5400 rpm
TORQUE: 382 lb-ft @ 4200 rpm

VORTEC 6.2L V-8 VVT (L94)

Active Fuel Management / FlexFuel Capable

HORSEPOWER: 403 hp @ 5700 rpm
TORQUE: 417 lb-ft @ 4300 rpm

ACTIVE FUEL MANAGEMENT To conserve fuel when extra power isn't needed, such as cruising at highway speeds, Active Fuel Management (not available on 6.0L V-8 [L96]) deactivates four of the eight cylinders to become a V-4. For passing, trailering or mountain terrain, pressing the accelerator can reactivate all eight cylinders in milliseconds. For even greater power when necessary in Hybrid models, the electric drive system can automatically engage for extra torque.

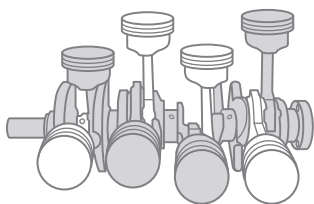

E85 FLEXFUEL CAPABILITY¹ To give you more choices at the pump, most Yukon Vortec V-8 engines are capable of running on E85 ethanol. This advanced biofuel is a mostly renewable fuel that burns cleaner than gasoline and helps to reduce vehicle emissions, as well as the need for imported oil.

VARIABLE VALVE TIMING (VVT) This feature monitors and changes valve open and close points for near-peak levels of torque across the entire range of engine speeds.

TRANSMISSION

6-SPEED AUTOMATIC OVERDRIVE TRANSMISSION Engineered for control and confidence in a wide variety of situations, the 6-speed automatic is standard in 1500 Series Yukon models, including Denali (except Hybrid and Denali Hybrid models). It's an ideal partner for Vortec power. Filled with innovative technology, this transmission can help you cut steep climbs, long grades and heavy loads down to size.

AUTOMATIC GRADE BRAKING Standard with 6-speed automatic transmissions, this feature can be activated in Tow/Haul mode—but disengaged with Driver Shift Control activated. Grade Braking automatically senses when you want to slow your Yukon, and when the conditions are met, engages a Grade Braking shift schedule that helps you maintain your desired speed.

POWERTRAINS

DRIVER SHIFT CONTROL Standard with 6-speed automatic transmissions, this feature lets you move through the gears with the precision of a manual transmission. Move the shift lever to “M,” and you get fingertip “tap up/down” control of transmission gear selection.

TOW/HAUL MODE This feature raises transmission upshift points, as well as helps slow your Yukon by raising downshift points, which helps you to use engine compression to slow your Yukon with less noise and harshness.

HYBRID POWERTRAIN

GASOLINE ENGINE

VORTEC 6.0L V-8 VVT HYBRID (LZ1 - HYBRID ONLY)

Active Fuel Management

HORSEPOWER: 332 hp @ 5100 rpm
TORQUE: 367 lb-ft @ 4100 rpm

ELECTRIC PROPULSION

300-VOLT NICKEL-METAL HYDRIDE (NiMH) BATTERY PACK NiMH battery technology can store a lot of energy in a small space. In fact, the 300-volt battery pack is strong enough to propel your Yukon from rest to over 25 mph on electric power alone, yet small enough to fit under the second-row seat between the steel frame rails. This leaves your cargo space and passenger capacity unchanged from other Yukons.

HYBRID ELECTRONICALLY VARIABLE TRANSMISSION To conserve fuel at low speeds or under light loads, this transmission has two integral electronic motors that engage to give you smooth, effortless power. At highway speeds or heavier loads with its 6.0L V-8 VVT engine engaged, it acts as a normal automatic transmission.

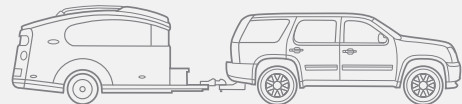
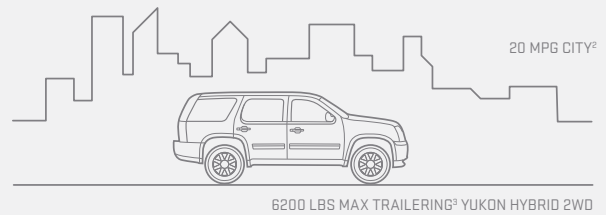

REGENERATIVE BRAKING SYSTEM During normal deceleration, regenerative braking uses the motors in the hybrid transmission as generators to slow the vehicle by applying electrical resistance, rather than using brake friction. At the same time, the motors are capturing that energy as electricity in the 300-volt battery pack, making that energy available for the next acceleration cycle.

STRENGTH AND RELIABILITY—ALL YUKON MODELS

ONSTAR VEHICLE DIAGNOSTICS⁴ The peace of mind that comes from knowing the condition of your Yukon's key systems is as easy as checking your e-mail. OnStar Vehicle Diagnostics is a service that is standard with your 6-month trial subscription to the Directions & Connections Plan and can run hundreds of checks of your Yukon's engine, transmission, antilock brakes and more, then organize the information into an easy-to-read monthly report. OnStar can also run a check of your vehicle as you drive just by pressing the blue button and asking the Advisor for an On-Demand Diagnostics check. That's peace of mind when you need it.

CHASSIS

COMPONENTS

AUTORIDE REAL-TIME DAMPING Engineered to eliminate the compromise between a comfortable ride and precise control, the available AutoRide System senses changes in the road surface and adjusts the shock absorbers as you drive.

¹E85 is a blend of 85 percent ethanol and 15 percent regular gasoline. Go to gmc.com and search E85 for more information about E85 as a fuel alternative. ²EPA-estimated. ³Maximum trailer weight ratings are calculated assuming a base vehicle, except for any option(s) necessary to achieve the rating, plus driver. The weight of other optional equipment, passengers and cargo will reduce the maximum trailer weight your vehicle can tow. See your GMC dealer for additional details. ⁴Capabilities vary by model. Visit onstar.com for details and system limitations.

EATON® HEAVY-DUTY AUTOMATIC LOCKING REAR DIFFERENTIAL

No other competitor in its class offers this automatic locking rear differential for on- or off-road use. When the Eaton locker senses the difference in rotational speed between left and right rear wheels of approximately 100 rpm, it locks the differential to turn both wheels in unison for added traction.

FULLY INDEPENDENT FRONT SUSPENSION The Yukon independent front suspension uses a strong and compact coil-over-shock system for a tight turn radius and a smooth ride. The 2500 Series models use an innovative torsion bar system that gives a smooth ride with no sacrifice in capability.

HILL START BRAKE ASSIST To help you hold your place when parked on an incline, Hill Start Brake Assist senses potential “roll-back” and then holds full brake pressure when you lift your foot from the pedal. It gives you up to 1½ extra seconds to apply power and drive off. (Not available on Hybrid models.)

INTELLIGENT BRAKE ASSIST In an abrupt stop, milliseconds can be your margin of safety. Intelligent Brake Assist senses when you are making an emergency stop, then automatically applies full braking force before your foot can press the pedal all the way.

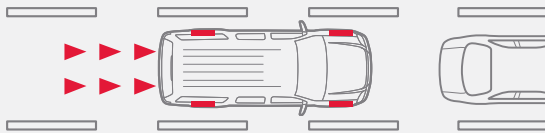

MULTILINK REAR COIL SPRING REAR SUSPENSION To give you a smooth, refined ride under a variety of road conditions, Yukon 1500 Series models are standard with a five-link rear coil spring rear suspension. For extra load-carrying capacity, the Yukon XL 2500 uses parallel leaf springs in place of coils.

REAR LEVEL CONTROL For a stable, level ride height under any load or passenger conditions, this system is included with the available AutoRide System (and Magnetic Ride Control on Denali Hybrid) to constantly sense and adjust rear suspension height. Available on SLT and standard on Denali models, this system uses an onboard compressor that pressurizes the air bladders inside the rear shocks until the Yukon is at level. Because this chamber is separate from the damping system of the shock absorbers, ride quality remains consistently comfortable.

STABILITRAK STABILITY CONTROL SYSTEM To help you stay in control when the road is loose, snowy, icy, wet or uneven, StabiliTrak uses a network of vehicle sensors to monitor how your Yukon is responding to your steering and braking commands. If the system determines your vehicle is not responding properly, it can pulse the brakes or reduce engine power to help you stay on the path being steered. StabiliTrak is not a substitute for common sense; please drive carefully within the limits of the road conditions and your vehicle’s capabilities.

TRACTION CONTROL SYSTEM For maximum traction on virtually any road surface, traction control measures and compares the speed of your drive wheels to the speed of your vehicle. If it senses a difference, this system manages the engine and brakes to equalize the speed of your wheels with your vehicle, so you can pull away smoothly with a strong sense of control.

TRAILER SWAY CONTROL Keep both you and your trailer heading in the proper direction, automatically. This system uses StabiliTrak system sensors to detect the rocking of a swaying trailer, and then applies the vehicle’s brakes and the trailer brakes (if properly equipped) to bring it back in line. (Not available on Hybrid models.)

ULTRA-LUXURY RIDE TUNING For smoothness and refinement that rival premium luxury sedans, Yukon Denali Hybrid features the remarkable capability of Magnetic Ride Control. This system senses changes in the road surface up to 1000 times per second, instantly adjusting the shock absorbers for maximum comfort and control, without sacrifice in agility.

STEERING

POWER RACK-AND-PINION STEERING Standard on all Yukon models, this provides a positive, on-center feel at highway speeds, as well as extra low-speed assist for maneuvering in tight spaces. Hybrid models use an electric power steering assist that eliminates the traditional hydraulic pump and connections to save weight and enhance fuel economy.⁵

BRAKING

ANTILOCK BRAKING SYSTEM (ABS) For confident stops in a variety of conditions, every Yukon features four-channel antilock brakes. When the brakes are applied, ABS can detect impending wheel lock-up, and then pulse that wheel’s brake to prevent it. The four-channel system can activate any combination of vehicle brakes to maintain control.

TRAILER BRAKE CONTROLLER For fingertip control and easy monitoring of your trailer brakes, Yukon offers an available integrated trailer brake controller. It is located close to the steering wheel for easy adjustments and displays the level of brake force or “gain” in the Driver Information Center.

DESIGN

ASSIST STEPS To give you a secure foothold for easy entry, assist steps are standard. Yukon Denali and Denali Hybrid models offer innovative power retractable assist steps that extend when the door is opened and retract when closed for a cleaner profile.

HEATED POWER-RETRACTABLE MIRRORS Standard on Denali and Hybrid models, and available on the SLT, these mirrors are heated to remove snow, frost and fogging and feature integrated turn indicators that signal your intentions to other drivers. The driver’s side mirror dims automatically to deflect glare away from your line of sight. Both mirrors fold back for extra clearance in close parking situations or to help prevent damage in automatic car washes.

REMOTE POWER LIFTGATE Loading up your Yukon with your hands full? Let us help you with that. The available power liftgate opens with a touch of your key fob for easier access to your Yukon’s impressive cargo capacity. You can close it the same way, or use the manual switch located on the liftgate itself or on the overhead center console.

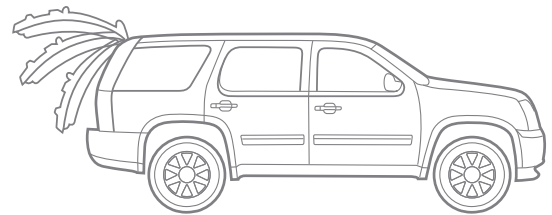
**SEATING**

POWER FRONT SEATING For the utmost in driver comfort, all Denali models are standard with leather-appointed 12-way power heated and cooled front bucket seats with perforated inserts that circulate cooled air between you and the seating surface in warm weather. On all SLT models, in addition to the available leather-appointed 10-way power heated front bucket seats, 10-way power heated and cooled seats are also available for added comfort.

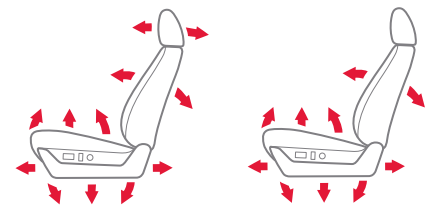

POWER FOLD-AND-TUMBLE SECOND-ROW SEATING An exclusive feature to GM vehicles, power fold-and-tumble seats are available for the second-row bench or captain’s chairs. Each seat automatically unlatches, folds and tumbles out of the way with simple one-hand operation for easy access to the third row. (Not available on SLE or Hybrid models.)

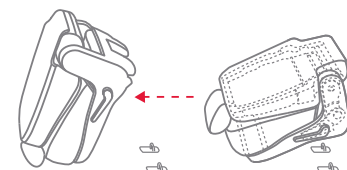

⁵EPA-estimated 20 city/23 hwy mpg.

INTERIOR STYLING

PREMIUM NUANCE LEATHER-APPOINTED SEATING SURFACES In Yukon Denali models, the ultra-soft feel of Nuance leather-appointed seating surfaces is standard in the first- and second-passenger rows to give the SUVs with the ultimate in capability the ultimate level of comfort.

SEATING CONFIGURATIONS Yukon comes standard with seating for eight, and with an available 40/20/40 front split bench, SLE models can comfortably accommodate up to nine passengers. On SLT models, second-row captain's chairs are also available. Yukon Denali comes standard with second-row captain's chairs, and with an available 60/40 second-row split-folding three-passenger bench seat, it can seat up to eight. Yukon Hybrid and Yukon Denali Hybrid both seat up to eight passengers.

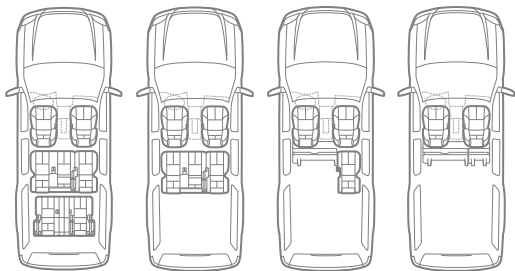

ENTERTAINMENT

AUXILIARY INPUT CAPABILITY Bring the music and entertainment you love to your Yukon just by plugging in a simple playback cable. Accommodates most MP3 players and devices, including iPod® and many smartphones.

AVAILABLE DEALER-INSTALLED WI-FI¹ Connect up to 20 wireless users at one time and stay in touch with your life's vital information with the first wireless router designed just for automotive use. It's called Autonet Wi-Fi and it allows any combination of laptops, phones or other Wi-Fi-enabled devices to connect to the Internet, wherever you are. Ask your dealer for specific plans and prices.

BLUETOOTH® FOR PHONE² Extend your capabilities just by activating the standard Bluetooth feature on your phone or portable device. This lets your Bluetooth device work through the controls and features already installed in your Yukon, including hands-free operation and dialing. With your Bluetooth device activated, turning the key automatically continues the conversation over the built-in hands-free phone system.

BOSE® AUDIO SYSTEMS Make the front seat of your Yukon sound like the front row of your favorite concert. Bose systems are engineered to give you the realism and presence of a live performance. Standard on SLE, SLT and Hybrid models, Bose audio features a premium speaker system with a center console-mounted woofer for rich bass tones that give you a fuller listening experience.

BOSE CENTERPOINT® SURROUND SOUND For the sensation of a live performance while you drive, Denali models have a standard Bose Centerpoint 10-speaker surround sound system with SurroundStage® signal processing. This technology, along with AudioPilot® noise compensation, wraps you in sound, delivering five independent channels from existing two-channel recordings.

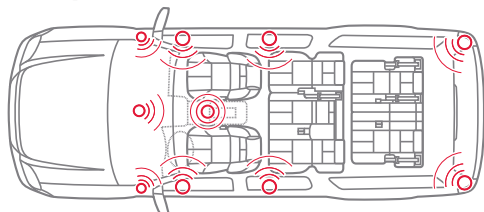

REAR-SEAT ENTERTAINMENT SYSTEM Let your rear-seat passengers enjoy the ride even more. This available system includes a DVD player and 8" flip-down screen. It also comes with dual-play, which has a separate upper DVD slot in the radio to let front-seat passengers control the DVD or music playing behind them. Yukon XL and Denali XL models feature two screens, with one screen specifically for the third-row passengers. This system is compatible with most popular video gaming systems.

INTERIOR STYLING

SiriusXM SATELLITE RADIO³ Enjoy SiriusXM Satellite Radio in your Yukon with a 3-month trial subscription to the XMPremier Package. Only SiriusXM brings you more of what you love, all in one place. Get over 130 channels, including commercial-free music plus the best sports, news, talk, comedy and entertainment. With NavTraffic,⁴ you'll get continuously updated traffic as it occurs, right on your vehicle's available navigation system. Welcome to the world of SiriusXM.

STEERING-WHEEL-MOUNTED RADIO CONTROLS Control your audio system with your fingertips as you keep your hands on the wheel. These controls adjust the radio band, channel selection, volume and muting, as well as manage the functions of your available hands-free phone service through OnStar or your mobile Bluetooth-enabled phone.²

INTERIOR

TOUCH-SCREEN NAVIGATION⁵ For easy operation, the available system includes a large 7" in-dash touch-screen display, 2-D or 3-D map graphics and 3 months of NavTraffic.⁴ OnStar subscribers can also use this system with OnStar Turn-by-Turn Navigation assistance. For your convenience, this screen also serves as a large, easily read monitor for the available Rear-Vision Camera System. Its sophisticated new features include a pause-and-play feature for live radio broadcasts that works like a DVR for your vehicle, a built-in hard drive, an available XMWeather subscription and improved display resolution for enhanced visibility and viewing.

USB CONNECTIVITY⁶ Plug into the available USB port and you can control most of your iPod® or MP3 music player's functions, including playlists and song selection, from your convenient steering-wheel-mounted radio controls.

CONVENIENCE

HEATED STEERING WHEEL Standard on Yukon Denali and available on SLT models, a built-in heating system warms the steering wheel rim to give you gloves-off comfort even on the coldest days.

POWER-ADJUSTABLE PEDALS To help drivers of varying sizes sit at a comfortable distance from the steering wheel, adjustable pedals are available in SLE models and are standard in SLT models and Denali. On Denali and SLT-2 models, the pedals also have a memory feature that automatically recognizes your key fob and moves the pedals back to your desired settings.

REAR-VISION CAMERA SYSTEM Make it easier to back up to a trailer or negotiate a tight space. This available system (standard in Denali and SLT models) places a monitor in your rearview mirror or navigation screen (if equipped) to display a view of the area behind the vehicle. The Rear-Vision Camera System does not replace driver vision. Please use proper care when backing up.

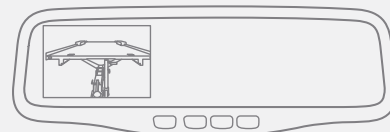

REMOTE VEHICLE START This available feature will start and run your Yukon for up to 10 minutes from up to 195 feet away. If your Yukon is equipped with automatic climate control, it will default to heating or cooling mode based on the outside temperature.

ULTRASONIC REAR PARKING ASSIST This feature sends out ultrasonic waves that alert you to certain objects up to 8' behind the vehicle. Available on SLE and standard on all other Yukon models, the system operates at 5 mph or less. The closer you are to an object, the faster it beeps, to give you a clear signal that can help you operate the vehicle with maximum care.

UNIVERSAL HOME REMOTE Never get locked out again. This available remote can be easily programmed to operate the majority of garage-door-opening systems and has the added benefit of never needing batteries.

¹Monthly rates apply. Visit autonetmobile.com for coverage map and details. ²Go to gm.com/bluetooth to see which Bluetooth phones are compatible with the vehicle. ³Requires a subscription, sold separately by SiriusXM after the trial period. SiriusXM Radio service only available in the 48 contiguous United States and the District of Columbia. For more information and to view Customer Agreement, visit siriusxm.com. ⁴NavTraffic requires a monthly subscription after introductory trial service, sold separately by SiriusXM. NavTraffic only available in select markets. For more information, visit siriusxm.com/navtraffic. ⁵Map coverage for Puerto Rico and the Virgin Islands available on separate disc. Coverage not available for portions of Canada. ⁶Not compatible with all devices.

DIRECTIONS & CONNECTIONS PLAN⁷ Non-stop communication and never-ending demands on your time place a premium on the ability to sort and focus the information of greatest importance to you. To place this capability at your fingertips, every Yukon has a 6-month trial subscription to the OnStar Directions & Connections Plan, standard.

HANDS-FREE CALLING WITH VOICE-ACTIVATED DIALING Available OnStar Hands-Free Calling is built into your Yukon. Just push a button, call out the number and you're free to keep your eyes on the road. It's reliable, because it is specially designed for better connectivity and fewer dropped calls in areas with limited cellular reception.

TURN-BY-TURN NAVIGATION Drive with more confidence and certainty. OnStar Turn-By-Turn Navigation is built into your Yukon. It's simple—all you have to do is push one button and ask the OnStar Advisor to download directions to your Yukon. Turn-By-Turn is also smart, because an automated voice calls out every turn, as you need it.

ONSTAR eNAV WITH GOOGLE™ MAPS AND ONSTAR eNAV WITH MAPQUEST.COM™ Want to get a head start on a trip? Start by checking out your destination on Google Maps or mapquest.com. With OnStar eNav, just click the "Send" link on the Web site, and it will be sent to your vehicle. When you're ready to head out, simply retrieve the destination and directions will be downloaded to your vehicle based on your location. With nothing to type on the screen and no maps to hold.

DESTINATION DOWNLOAD Looking for a destination in your vehicle's screen-based navigation system? OnStar will do it for you. Simply press your blue OnStar button, and you will be connected with a trained Advisor who will download your directions to your Yukon's screen-based navigation system. You can also have Destination Downloaded on the go—no need to pull over to enter new addresses. It's an enhancement to navigation that makes screen-based navigation systems easier and faster to use.

AUTOMATIC CRASH RESPONSE If your Yukon is in a crash, built-in sensors can automatically send an alert to OnStar. An OnStar Advisor is immediately connected to your vehicle to help you. Even if you aren't capable of responding, the Advisor can use GPS technology to locate you and request that emergency help is sent right away.

CRISIS ASSIST During severe weather or other natural disasters, OnStar can offer assistance and help you navigate your way to safety. Just push the red OnStar emergency button and our specially trained Crisis Assist Team moves quickly to help you. OnStar can pinpoint your location and provide up-to-date information from public safety authorities, request that help be sent to you or even contact family members or loved ones.

EMERGENCY SERVICES If someone in your Yukon needs emergency help, the OnStar emergency button gives you a priority connection to a specially trained Advisor at any time, day or night. OnStar uses GPS technology to pinpoint your location and can request police, fire or medical support be sent right away. The Advisor can also stay with you until help arrives.

STOLEN VEHICLE ASSISTANCE If your Yukon is ever stolen, OnStar can help to locate it after verification with law enforcement. OnStar can use built-in GPS technology to help locate it, prevent it from restarting with Remote Ignition Block or, if the vehicle is in use, engage the Stolen Vehicle Slowdown technology to help police recover it quickly and safely.

ROADSIDE ASSISTANCE⁸ If the unexpected happens on the road—you're stranded, run out of gas or have a flat tire—one push of the OnStar button can immediately connect you to an Advisor, ready to help any hour of the day or night. OnStar can use GPS technology to pinpoint your location and connect you to a service provider. No guessing about where you are or what to do.

REMOTE DOOR UNLOCK It's happened to everyone. But there is an easy solution. If you get locked out of your Yukon, OnStar can help. After verifying your account, an OnStar Advisor can send a remote signal to your Yukon that usually unlocks the doors within minutes.

REMOTE HORN AND LIGHTS Say you're in a large parking area and you just can't remember where you parked. Just call the toll-free number and OnStar can send a remote signal to flash your lights and sound your horn to help you locate your Yukon.

ONSTAR REMOTELINK APP The OnStar Remotelink app offers an amazing level of control and connection with your vehicle. After downloading and registering the app, GMC owners with an eligible vehicle can use their iPhone® or Android™-based mobile devices to control their vehicle from their phone and perform specific commands—like unlocking their doors—remotely. You can lock/unlock your doors from any distance, start your vehicle remotely,⁹ flash your lights and sound your horn to help locate your vehicle or contact an OnStar Advisor, Roadside Assistance or your preferred dealer. To learn all about all the great features available, go to onstar.com.



DUAL-STAGE FRONTAL AIR BAGS¹⁰ To help reduce the risk of injury to the driver and front passengers, the dual-stage frontal air bags in Yukon have sensors that gauge the severity of a crash, then determine whether to employ one or two levels of inflation. Yukon also features a Passenger Sensing System for the outboard front passenger that automatically turns off the air bag if the passenger is under the appropriate weight.

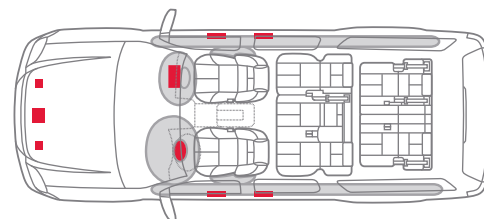

HEAD CURTAIN SIDE-IMPACT AIR BAGS¹⁰ These air bags unfurl from the roof rail like a protective curtain for outboard passengers and can be activated by either rollover sensors or side-impact sensors.

SIDE-IMPACT AIR BAGS¹⁰ To help protect the thorax and pelvic regions of the driver and outside front passenger in a side-impact collision, Yukon models include standard side-impact air bags mounted on the driver and outside front passenger seats.

LATCH CHILD SEAT ANCHORING SYSTEM Make it easier to properly install a child seat. LATCH stands for Lower Anchors and Top tethers for Children. It means that a LATCH-equipped child seat will install to specially designed retainer hooks in your Yukon. LATCH also enables a child seat top tether strap to be attached that helps limit movement in a forward crash to help reduce the chance of injury.

PASS-KEY III THEFT DETERRENT SYSTEM Preventing unauthorized starting attempts in your Yukon comes down to a tiny chip found in your ignition key. It functions as an electronic "fingerprint" that disables your starting system if it detects a theft is underway.

SIDE BLIND ZONE ALERT¹¹ This feature alerts you to the proximity of other vehicles in the areas around your Yukon that may be hard to see. It's standard on Denali and available in SLT. The system uses alternating radar beams to sweep adjacent traffic lanes, covering a zone approximately one lane over from each side of the vehicle. A dedicated amber icon next to the outside rearview mirror's turn-signal display lights up any time there is a vehicle in the blind spot and flashes if you activate the turn signal.

TIRE PRESSURE MONITORING SYSTEM Properly inflated tires are important to your comfort, vehicle control and economy. This system uses tiny sensors inside the wheel to "broadcast" tire pressure to your vehicle,¹² which alerts you to their status and inflation level through the Driver Information Center. If you subscribe to OnStar Vehicle Diagnostics, this information is part of their monthly e-mail update, or if you have the OnStar Remotelink app, you can check the status.

⁷Visit onstar.com for coverage map, details and system limitations. OnStar acts as a link to existing emergency service providers. Services vary with conditions. ⁸Roadside service provided by Cross Country. ⁹Requires factory-installed remote start. ¹⁰Air bag inflation can cause severe injury or death to anyone too close to the air bag when it deploys. Be sure every occupant is properly restrained. Always use safety belts and the correct restraint for your child's age and size. Even in vehicles equipped with the Passenger Sensing System, children are safer when properly secured in a rear seat in the appropriate infant, child or booster seat. Never place a rear-facing infant restraint in the front seat of any vehicle equipped with a passenger air bag. See the Owner's Manual and child safety seat instructions for more safety information. ¹¹Before making a lane change, always check the Side Blind Zone Alert display, check the side and inside rearview mirrors, look over your shoulder for vehicles and hazards and start the turn signal. ¹²Does not monitor spare tire.



PART 3
SPEC YOUR MODEL

GMC.COM/EXPLOREYUKON

TRIM LEVELS

SLE
SLT
DENALI
HYBRID
DENALI
HYBRID

MECHANICAL

ALTERNATOR 160-amp. Requires Snow Plow Prep Package on 3/4-ton models.	S	S	S	-	-
145-amp, 3/4-ton models	S	S	-	-	-
BATTERY Heavy-duty maintenance-free with 730 cold-cranking amps and rundown protection	-	-	-	S	S
Battery Pack 300-volt hybrid, located under second-row seat cushion	-	-	-	S	S
BRAKES 4-wheel Antilock Brake System (ABS), 4-wheel disc	S	S	S	S	S
DRIVETRAIN 2WD	S	S	S	S	S
4WD. Single-speed active transfer case.	S	S	-	-	-
4WD. Active 2-speed transfer case with rotary controls. Included with Heavy-Duty Trailing Package.	A	A	-	S	S
All-Wheel Drive (AWD). Electronic automatic system; includes AWD transfer case.	-	-	A	-	-
ENGINES Vortec 5.3L V-8 VVT FlexFuel with Active Fuel Management, E85 capable	S	S	-	-	-
Vortec 6.0L V-8 VVT Hybrid with Active Fuel Management	-	-	-	S	S
Vortec 6.0L V-8 VVT, requires 3/4-ton models	S	S	-	-	-
Vortec 6.2L V-8 VVT with Active Fuel Management, E85 capable	-	-	S	-	-
ENGINE BLOCK HEATER	A	A	A	-	-
EXTERNAL ENGINE OIL COOLER Heavy-duty air-to-oil, integral to radiator. Requires Heavy-Duty Trailing Package on 1/2-ton Yukon and XL models. Standard on 3/4-ton models.	A	A	S	-	-
HEAVY-DUTY AUTOMATIC LOCKING REAR DIFFERENTIAL	S	S	S	S	S
HIGH-VOLTAGE MANAGEMENT Power electronics module	-	-	-	S	S
REGENERATIVE BRAKING	-	-	-	S	S
STABILITRAK Stability control system and traction control. Includes trailer sway control and Hill Start Brake Assist. (Not available on Hybrid models.)	S	S	S	S	S
STEERING Power. On Hybrid models, includes 42-volt electric power.	S	S	S	S	S
SUSPENSION Front independent coil-over-shock with stabilizer bar. 1/2-ton models only.	S	S	S	S	S
Front independent with torsion bar. 3/4-ton models only.	S	S	-	-	-
Rear multilink with coil springs. Leaf springs on 3/4-ton models.	S	S	S	S	S
Automatic Rear Level Control, air. 1/2-ton models only.	-	A	S	-	S
Magnetic Ride Control, road sensing, electronically controlled shock absorbers	-	-	-	-	S
Premium Smooth Ride Suspension	S	S	-	S	-
AutoRide Suspension Package. Bi-state variable shock dampening and rear air-assisted load-leveling, includes automatic air-level control. Not available on 3/4-ton models.	-	A	S	-	-
Z71 Off-Road Suspension Package. Available only on Yukon SLE and SLT 4WD and 1/2-ton XL 4WD models. Includes Skid Plate Package, P265/70R17 on-/off-road, blackwall tires and high-capacity air cleaner on all models. Not available with SLT Chrome Package.	A	A	-	-	-
TRAILERING Trailer Brake Controller, integrated. On SLE and SLT, requires Heavy-Duty Trailing Package. Standard on 3/4-ton models.	A	A	A	-	-
Trailing Equipment. Includes hitch platform with 2" trailing receiver and 7-wire harness with independent fused trailing circuits mated to a 7-way sealed connector.	S	S	S	S	S
TRANSMISSION 6-speed automatic, heavy-duty, electronically controlled with overdrive, Tow/Haul mode and tap up/tap down shifting	S	S	S	-	-
2-mode strong hybrid automatic electronic with Tow/Haul mode built in to the software	-	-	-	S	S

A-Available S-Standard - -Not Available

TRIM LEVELS

SLE
SLT
DENALI
HYBRID
DENALI
HYBRID

PACKAGES

CONVENIENCE PACKAGE Includes power-adjustable pedals, remote vehicle start, Rear Parking Assist, inside rearview mirror with rear camera display and Rear-Vision Camera System	A	-	-	-	-
HEAVY-DUTY TRAILERING PACKAGE Includes auxiliary external transmission oil cooler, external engine oil cooler, power steering cooler and increased-capacity radiator and cooling fans. Includes 3.42 rear axle ratio. Not available on 3/4-ton models. Includes 2-speed AutoTrac on 4WD models. Heavy-Duty Handling/Trailing Suspension. 3/4-ton models only.	A	A	-	-	-
REGIONAL VALUE PACKAGE Includes outside heated power-adjustable, power-folding and driver-side auto-dimming mirrors, 1 year of SiriusXM Satellite Radio service, ¹ 20" polished aluminum wheels, Heavy-Duty Trailing Package, chrome door handles, chrome mirror caps, polished exhaust tip (dealer installed), chrome recovery hooks and chrome grille (dealer installed). Not available with Sun, Entertainment & Destination Package or 20" chrome-clad wheels.	-	A	-	-	-
SKID PLATE PACKAGE Includes front underbody shield. Requires 4WD models and Z71 Off-Road Suspension Package. Standard on 3/4-ton models.	A	A	-	-	-
SLT CHROME PACKAGE Includes chrome door handles, chrome mirror caps, polished exhaust tip, chrome recovery hooks, chrome grille, outside heated power-adjustable, power-folding and driver-side auto-dimming body-color mirrors and 20" polished aluminum wheels. Not available with Z71 Off-Road Suspension Package.	-	A	-	-	-
SLT-2 EQUIPMENT PACKAGE Includes 10-way power leather-appointed heated front bucket seats, heated second-row seats, second-row power seat release, rear power liftgate and outside heated power-adjustable, power-folding mirrors with memory feature. Includes heated, leather-wrapped steering wheel with 1/2-ton models.	-	A	-	-	-
SNOW PLOW PREP PACKAGE Includes instrument panel switch, roof beacon wiring, forward lamp wiring and torsion bar (3/4-ton models only)	A	A	-	-	-
SUN, ENTERTAINMENT & DESTINATION PACKAGE Includes 1 year of SiriusXM Radio ¹ and NavTraffic ² service, power sunroof, inside rearview auto-dimming mirror, audio system with navigation and Rear-Seat Entertainment System. On SLT models, not available with AM/FM stereo with CD player and MP3 playback, or audio system with Rear-Seat Entertainment System.	-	A	A	-	-
TEXAS EDITION Includes Regional Value Package features plus Texas Edition badge	-	A	-	-	-
SEATS 40/20/40 front split-bench, 3-passenger with Premium Cloth. Includes 6-way power driver seat adjuster, driver and front-passenger manual reclining, center fold-down armrest with storage, lockable storage compartments in seat cushion (includes auxiliary power outlet), outboard adjustable head restraints and storage pockets.	A	-	-	-	-
Front buckets. Includes 6-way power driver and passenger seat adjuster, outboard adjustable head restraints, floor console and rear storage pockets. Premium Cloth on SLE models. Leather-appointed first and second row with heated front seat cushion and seatbacks on SLT and Hybrid.	S	S	-	S	-
Leather-appointed seats on the first and second rows. Includes front bucket seats with 10-way power driver and front-passenger seat adjusters, including power lumbar control, heated seat cushion and seatbacks, 2-position driver memory, adjustable head restraints, storage pockets and floor console. Requires SLT-2 Equipment Package.	-	A	-	-	-

TRIM LEVELS

	SLE	SLT	DENALI	HYBRID	DENALI HYBRID
Heated and cooled perforated leather-appointed seats on first row and heated perforated leather-appointed seats on second row. Includes front bucket seats with 10-way power driver and front-passenger seat adjusters (12-way on Denali models), including power lumbar control, heated and cooled seat cushions and seatbacks, 2-position driver memory, adjustable head restraints, storage pockets and floor console. SLT models require SLT-2 Equipment Package.	-	A	S	-	S
60/40 second-row split-folding 3-passenger bench in Premium Cloth, with center armrest and storage tray	S	-	-	-	-
60/40 second-row split-folding 3-passenger leather-appointed bench with center armrest and storage tray	-	S	A	S	S
Leather-appointed second-row reclining captain's chairs. On Denali, includes heated cushions.	-	A	S	-	-
Heated second-row seat cushions. On bench seating, outboard positions only.	-	A	S	-	S
Flip and fold power second-row seat release for captain's chairs or bench seat. Requires front bucket seats with leather-appointed seating surfaces.	-	A	S	-	-
50/50 third-row split-bench seats, 3-passenger, removable, all belts-to-seat	S	S	S	S	S

INSTRUMENTATION AND CONTROLS

INSTRUMENTATION Analog cluster with speedometer, odometer/trip odometer, fuel level, voltmeter, engine temperature, oil pressure and tachometer. Driver Information Center including temperature and compass. Hybrid models include efficiency gauge.	S	S	S	S	S
POWER-ADJUSTABLE PEDALS On SLE models, included and only available with Convenience Package	A	S	S	S	S
REAR-VISION CAMERA SYSTEM With auto-dimming inside rearview mirror display. SLE models require Convenience Package.	A	S	-	-	-
With NAV-screen display. Requires Touch-Screen Navigation.	-	A	S	S	S
STEERING WHEEL Leather-wrapped, with controls for audio, cruise control and Bluetooth-enabled ⁵ phone, plus tilt-adjustable column with brake/transmission shift interlock. Deluxe leather-wrapped with power-tilt on Denali and Denali Hybrid.	S	S	S	S	S
Heated steering wheel	-	A	S	-	-
TOW/HAUL MODE SELECTOR Built-in automatic on Hybrid models	S	S	S	S	S
ULTRASONIC REAR PARKING ASSIST With audible warning. On SLE models, included and only available with Convenience Package.	A	S	S	S	S

INTERIOR DETAILS AND CONVENIENCE FEATURES

CARPET Color-keyed with removable carpeted floor mats for first and second rows	S	S	S	S	S
CLIMATE CONTROL Tri-zone manual air conditioning. Available on SLE models with bench seat.	A	-	-	-	-
Tri-zone automatic air conditioning, includes individual climate settings for driver and right-front passenger. On SLE, not available with optional 40/20/40 front split-bench seating.	S	S	S	S	S
Rear auxiliary heater and air conditioner with rear-passenger heating and air ducts	S	S	S	S	S
Defogger, rear-window electric	S	S	S	S	S
CONSOLES Overhead mini with map lights	S	S	S	S	S
Floor with storage area, cupholders and integrated second-row audio and HVAC controls. Included and only available with front bucket seats.	S	S	S	S	S
Storage bin behind driver-side rear quarter panel	S	S	S	S	S
CUPHOLDERS Front seating area, rear floor console, third-row outboard side trim	S	S	S	S	S
MIRROR Auto-dimming rearview	S	S	S	S	S

TRIM LEVELS

	SLE	SLT	DENALI	HYBRID	DENALI HYBRID
OUTLETS 12-volt power, 5	S	S	S	S	S
PADDED VISORS AND ARMRESTS	S	S	S	S	S
POWER PROGRAMMABLE DOOR LOCKS	S	S	S	S	S
POWER WINDOWS With driver express-down and lockout protection	S	S	S	S	S
REMOTE STARTER SYSTEM With keyless entry. On SLE models, requires Convenience Package.	A	S	S	S	S
SUNROOF Power, tilt-sliding with express-open and -close and wind deflector	A	A	A	A	A
UNIVERSAL HOME REMOTE Includes programmable garage door opener. Deleted on XL models when Snow Plow Prep Package is ordered.	-	S	S	S	S

ENTERTAINMENT/COMMUNICATION/NAVIGATION

AUDIO SYSTEM AM/FM stereo with CD player and MP3 playback, seek-and-scan, digital clock, auto-tone control, Radio Data System (RDS), ⁴ speed-compensated volume, TheftLock, auxiliary input jack and USB port ⁵	S	S	-	-	-
TOUCH-SCREEN NAVIGATION⁶ AM/FM/SiriusXM ¹ stereo with CD/DVD player and MP3/WMA playback, color touch-screen display, enhanced HDD-based navigation with voice recognition, hard drive with memory available for music storage, USB port, ⁵ RDS ⁴ and pause/play radio	-	A	S	S	S
REAR-SEAT ENTERTAINMENT SYSTEM Includes DVD player with remote control, overhead display, 2 sets of 2-channel wireless infrared headphones and auxiliary audio/video input jacks. Requires AM/FM stereo with MP3-compatible CD/DVD player or AM/FM stereo with MP3-compatible CD/DVD player and Touch-Screen Navigation. ⁶	A	A	A	A	A
REAR AUDIO SYSTEM CONTROLS With 2 headphone jacks (headphones not included), power outlet and controls for volume, station selection and media	S	S	S	S	S
AUDIO 6-speaker system included with bench seat	A	-	-	-	-
9-speaker Bose [®] sound system with subwoofer in center console. Not available with optional bench seat.	S	S	-	S	-
10-speaker Bose Centerpoint [®] surround sound system	-	-	S	-	S
PREMIUM ACOUSTICAL INSULATION PACKAGE	-	-	S	-	S
DUAL-SCREEN ENTERTAINMENT SYSTEM Adds second screen for third-row passengers. Includes 2 additional sets of headphones. Included and only available with Rear-Seat Entertainment System. Available on XL models only.	-	A	A	-	-
ONSTAR 6 months of Directions & Connections Plan ⁷	S	S	S	S	S
SiriusXM SATELLITE RADIO¹ 3 trial months included	S	S	S	S	S
NAVTRAFFIC² 3 trial months included. 3 years included on Hybrid models. Included and only available with Touch-Screen Navigation.	-	A	S	S	S
BLUETOOTH[®] FOR PHONE³ Personal cell-phone connectivity	S	S	S	S	S

EXTERIOR STYLING AND FUNCTIONALITY

ASSIST STEPS Black	S	S	-	S	-
Body-color with chrome inserts	-	-	S	-	S
Power-retractable. Requires AutoRide Suspension Package. On SLT models, requires SLT-2 Equipment Package. Not available on ¾-ton models or Hybrid.	-	A	A	-	-
GLASS Solar-Ray deep-tinted. All windows except light-tinted glass on windshield and driver- and front-passenger-side glass.	S	S	S	S	S

¹Requires a subscription, sold separately by SiriusXM after the trial period. SiriusXM Radio service only available in the 48 contiguous United States and the District of Columbia. For more information and to view Customer Agreement, visit siriusxm.com. ²NavTraffic requires a monthly subscription after introductory trial service, sold separately by SiriusXM. NavTraffic only available in select markets. For more information, visit siriusxm.com/navtraffic. ³Go to gm.com/bluetooth to find out which Bluetooth phones are compatible with the vehicle. ⁴RDS functions only where stations broadcast RDS information. ⁵Not compatible with all devices. ⁶Map coverage for Puerto Rico and the Virgin Islands available on separate disc. Coverage not available for portions of Canada. ⁷Visit onstar.com for details and system limitations.

PART 3
SPEC YOUR MODEL (CONTINUED)

TRIM LEVELS	SLE	SLT	DENALI	HYBRID	DENALI HYBRID
EXTERIOR STYLING AND FUNCTIONALITY (CONTINUED)					
LIGHTS Dual halogen composite headlamps with automatic exterior lamp control and flash-to-pass	S	S	S	S	S
Halogen front fog lamps, round	S	S	S	S	S
LUGGAGE RACK Roof-mounted side rails, black; bright accent on Yukon Denali and Denali Hybrid models	S	S	S	-	S
LUGGAGE RACK CENTER RAILS	S	S	S	-	S
OUTSIDE MIRRORS Heated, power-adjustable, manual-folding, body-color	S	S	-	-	-
Heated power-folding, power-adjustable, driver-side auto-dimming, body-color mirrors with integrated turn-signal indicators, ground illumination and curb-tilt. On SLT models, requires SLT-2 Equipment Package.	-	A	S	S	S
Vertical camper, heated, power-adjustable, manual-folding, includes integrated turn-signal indicators (¾-ton models only)	A	A	-	-	-
POWER LIFTGATE On SLT models, requires SLT-2 Equipment Package. Not available with Snow Plow Prep Package on XL models.	-	A	S	-	S
RECOVERY HOOKS 2 front, frame-mounted	S	S	S	-	S
WIPERS Front intermittent wet-arm with flat blade and pulse washers	S	S	S	S	S
Rear intermittent with washer	S	S	S	S	S

TRIM LEVELS	SLE	SLT	DENALI	HYBRID	DENALI HYBRID
SAFETY AND SECURITY					
AIR BAGS¹ Dual-stage frontal with Passenger Sensing System	S	S	S	S	S
Front and rear head curtain side-impact air bags for all outboard seating positions with rollover sensor	S	S	S	S	S
Front-seat-mounted side-impact driver and right front passenger air bags for thorax and pelvis protection ¹	S	S	S	S	S
SIDE BLIND ZONE ALERT On SLT ½-ton models only, requires SLT-2 Equipment Package	-	A	S	-	S
TIRE PRESSURE MONITORING SYSTEM (Does not monitor spare)	S	S	S	S	S
VEHICLE THEFT-DETERRENT SYSTEM PASS-Key III	S	S	S	S	S

YUKON/YUKON XL/YUKON DENALI/YUKON XL DENALI/SPECIFICATIONS

	LMG	LC9	L96	L94	LZ1 HYBRID
ENGINE	VORTEC 5.3L V-8 VVT	VORTEC 5.3L V-8 VVT	VORTEC 6.0L V-8 VVT	VORTEC 6.2L V-8 VVT	VORTEC 6.0L V-8
HP@RPM	SWB: 320 @ 5400 LWB: 320 @ 5400	- LWB: 320 @ 5400	- LWB: 352 @ 5400	SWB: 403 @ 5700 LWB: 403 @ 5700	SWB: 332 @ 5100 -
LB-FT TORQUE@RPM	SWB: 335 @ 4000 LWB: 335 @ 4000	- LWB: 335 @ 4000	- LWB: 382 @ 4200	SWB: 417 @ 4300 LWB: 417 @ 4300	SWB: 367 @ 4100 -
ACTIVE FUEL MANAGEMENT	Included	Included	-	Included	Included
E85 CAPABLE	Included	Included	-	Included	-
EPA-ESTIMATED CITY/HWY MPG	15/21 GAS 11/16 E85	15/21 GAS 11/16 E85	10/16 GAS (2WD) 10/15 GAS (4WD)	14/18 GAS (2WD) 10/15 E85 (2WD) 13/18 GAS (AWD) 10/14 E85 (AWD)	20/23 GAS
STANDARD	YUKON YUKON XL 2WD	YUKON XL 4WD	YUKON XL ¾-TON	YUKON DENALI YUKON XL DENALI	YUKON HYBRID YUKON DENALI HYBRID

MEASUREMENTS/CAPACITIES

	2WD	4WD	2WD	4WD	YUKON DENALI	YUKON XL DENALI
	YUKON	YUKON	YUKON XL ½-TON / ¾-TON	YUKON XL ½-TON / ¾-TON		
TURNING DIAMETER curb to curb, ft.	39.0	39.0	43.0 / 45.3	43.0 / 45.3	39.0	43.0
WHEELBASE in.	116.0	116.0	130.0	130.0	116.0	130.0
MAXIMUM CARGO VOLUME² cu.ft.	108.9	108.9	137.4	137.4	108.9	137.4
OVERALL LENGTH in.	202.0	202.0	222.4	222.4	202.0	222.4
OVERALL WIDTH in.	79.0	79.0	79.1	79.1	79.0	79.1
HEIGHT in.	76.9	76.9	76.8	76.8	77.0	77.1
FUEL TANK CAPACITY approx. gallons	26.0 (25.0 Hybrid)	26.0 (25.0 Hybrid)	31.0 / 39.0	31.0 / 39.0	26.0 (25.0 Hybrid)	31.0

A-Available S-Standard - -Not Available SWB-Short Wheelbase LWB-Long Wheelbase

GMC ACCESSORIES FOR YOUR YUKON

Express yourself. Genuine GMC Accessories are the only accessories engineered and tested to meet the standards of your Yukon. They are available individually, or as a part of a complete package that's ready to enjoy the moment you take delivery. It's the easiest way to make Yukon all yours, while still keeping it all Professional Grade. To see how easy it is to personalize your new Yukon, just ask.

CHROME GRILLE



This chrome grille is specifically designed and engineered for your vehicle. It has a chrome surround and features the GMC logo.

TRAILER HITCH CLOSEOUT



This custom-molded cover hides the trailer hitch receiver when not in use. Available in select body colors. Not available for Yukon Denali or Yukon XL Denali.

SPLASH GUARDS



Make it easier to get in and out of your Yukon with these stylish assist steps. Crafted from rust-resistant stainless steel, they come as 6-inch oval chrome steps.

ACCESSORY WHEELS:³ 20" AND 22" CAST ALUMINUM WHEELS

Roll with the best. These custom wheels feature a brilliant, durable chrome or two-tone black gloss and polished finish, and are available with matching lugs and GMC center caps.



YUKON/YUKON XL/YUKON DENALI/YUKON XL DENALI /SPECIFICATIONS

MODEL	DRIVETRAIN / TRANSMISSION
YUKON /YUKON XL 1/2- TON	2WD or 4WD / Hydra-Matic 6-speed electronically controlled automatic with Driver Shift Control and Tow / Haul mode
YUKON /YUKON XL 3/4- TON	2WD or 4WD / Hydra-Matic 6-speed electronically controlled automatic with Driver Shift Control and Tow / Haul mode
YUKON DENALI	2WD or 4WD / Hydra-Matic 6-speed electronically controlled automatic with Driver Shift Control and Tow / Haul mode
YUKON HYBRID	2WD or 4WD / Electronically controlled automatic with built-in Tow/Haul mode
YUKON DENALI HYBRID	2WD or 4WD / Electronically controlled automatic with built-in Tow/Haul mode

MAXIMUM TRAILER WEIGHT RATINGS⁴

MODEL	YUKON VORTEC 5.3L		YUKON XL VORTEC 5.3L		YUKON XL VORTEC 6.0L		YUKON DENALI/ YUKON XL DENALI VORTEC 6.2L		YUKON HYBRID/ YUKON DENALI HYBRID VORTEC 6.0L HYBRID	
	AXLE RATIO	MAX. TRAILER WEIGHT LBS	AXLE RATIO	MAX. TRAILER WEIGHT LBS	AXLE RATIO	MAX. TRAILER WEIGHT LBS	AXLE RATIO	MAX. TRAILER WEIGHT LBS	AXLE RATIO	MAX. TRAILER WEIGHT LBS
1500 2WD	3.08 / 3.42	5500 / 8500	3.08 / 3.42	5100 / 8100						
1500 4WD	3.08 / 3.42	5200 / 8200	3.08 / 3.42	5000 / 8000						
2500 2WD					3.73	9600				
2500 4WD					3.73	9400				
DENALI 2WD							3.42	8300 / 7900		
DENALI 4WD							3.42	8100 / 7800		
YUKON HYBRID 2WD/4WD									3.08/3.08	6200 / 5900
YUKON DENALI HYBRID 2WD/4WD									3.08/3.08	6000 / 5700

¹Always use safety belts and the correct restraint for your child's age and size. Even in vehicles equipped with the Passenger Sensing System, children are safer when properly secured in a rear seat in the appropriate infant, child or booster seat. Never place a rear-facing infant restraint in the front seat of any vehicle equipped with a passenger air bag. See the Owner's Manual and child safety seat instructions for more safety information. ²Cargo and load capacity limited by weight and distribution. ³Use only GM-approved wheel and tire combinations. Unapproved combinations may change the vehicle's performance characteristics. For approved wheel and tire combinations and other important information, go to gmaccessorieszone.com or see your dealer for details. ⁴Maximum trailer weight ratings are calculated assuming a base vehicle, except for any option(s) necessary to achieve the rating, plus driver. The weight of other optional equipment, passengers and cargo will reduce the maximum trailer weight your vehicle can tow. See your dealer for details.

COMMITMENT PLUS

From the owner orientation—and full tank of gas—you receive when you take possession of your Yukon to the **24-Hour Roadside Assistance, Courtesy Transportation and Travel Benefits**, Commitment Plus is a portfolio of owner privileges that lasts throughout your warranty. For expert product information, Roadside Assistance or other services, call 1-800-GMC-8782.

TRAVEL BENEFITS AND ROADSIDE ASSISTANCE Available around the clock: trip routing service, a program for reimbursement for trip interruption due to necessary warranty repairs, towing, flat tire change, jump-starts and more for 5 years or 100,000 miles (whichever comes first).

COURTESY TRANSPORTATION Available at participating dealers: shuttle service, reimbursement of certain public transportation or fuel expenses for overnight warranty repairs, and courtesy rental for overnight work repairs. See your dealer for details.

GMC OWNER CENTER A complimentary, one-stop resource to enhance your GMC ownership experience. It's easy to sign up. Just go to gm.com/gmownercenter/gmc.

ONSTAR



OnStar is a core asset of your Yukon. Benefiting from more than a decade of innovative development, it is both a highly advanced technology—fully integrated within the vehicle—and a warm human service. Standard on all Yukon models are 6 months of the OnStar Directions & Connections Plan, including the convenience of available Hands-Free Calling. It also includes Automatic Crash Response, Stolen Vehicle Assistance, link to Emergency Services, Roadside Assistance, Remote Door Unlock, OnStar Vehicle Diagnostics, Crisis Assist and Remote Horn and Lights. OnStar services require vehicle electrical system (including battery), wireless service and GPS satellite signals to be available and operating for features to function properly. OnStar acts as a link to existing emergency service providers. Visit onstar.com for coverage maps, details and system limitations. Services vary with conditions.

HANDS-FREE CALLING

Available OnStar Hands-Free Calling capability is built into your Yukon. It's there when your cell phone is unavailable, its battery is low, you can't reach it easily or you left it at home or in the office. Your Hands-Free Calling system is the right choice whenever you need an easy way to make and receive calls—at the touch of the phone icon on the rearview mirror or the steering-wheel-mounted controls. Voice-activated dialing is convenient because you don't have to dial when you are at the wheel. And Hands-Free Calling is reliable because it's specially designed for better reception and fewer dropped calls in areas of limited cellular reception.

ONSTAR TURN-BY-TURN NAVIGATION

Standard on all Yukon models are 6 months of the OnStar Directions & Connections Plan that adds innovative, easy-to-use Turn-by-Turn Navigation plus Information and Convenience Services and Driving Directions. With Turn-by-Turn Navigation, you simply tell the OnStar Advisor your intended destination, and directions will automatically be sent to your Yukon. If you drive off course, the system can reroute you to your intended destination. An automated voice then guides you turn-by-turn until you arrive at your destination. Turn-by-Turn Navigation is further enhanced with eNAV, allowing you to send Google™ Maps and MapQuest™ directions directly to your vehicle. No need to print out directions; just call them up with simple voice commands.

SIRIUSXM SATELLITE RADIO



SiriusXM Satellite Radio¹ is standard on all Yukon models. It includes 3 trial months of service. SiriusXM Satellite Radio makes your drive come alive with commercial-free music channels from virtually every genre, artist-dedicated channels, live performances and more. Tune in to live play-by-play from the biggest sports, exclusive entertainment from top personalities, compelling talk, hilarious comedy, world-class news, local traffic and weather and family-friendly programming. Welcome to the world of satellite radio. Visit siriusxm.com for details.

GMC CERTIFIED SERVICE

GMC Certified Service To help your Yukon live up to its performance promise, GMC Certified Service—found exclusively at your GMC dealer—is there. With all the engineering excellence in Yukon, GM-trained technicians have the expertise to care for all of it.

A NOTE ON CHILD SAFETY Always use safety belts and the correct restraint for your child's age and size. Even in vehicles equipped with the Passenger Sensing System, children are safer when properly secured in a rear seat in the appropriate infant, child or booster seat. Never place a rear-facing infant restraint in the front seat of any vehicle equipped with a passenger air bag. See the Owner's Manual and child safety seat instructions for more safety information.

TRAILERING AND OFF-ROAD INFORMATION Please carefully review the Owner's Manual for important safety information about trailering or off-road driving in your vehicle.

IMPORTANT WORDS ABOUT THIS CATALOG We have tried to make this catalog comprehensive and factual. We reserve the right, however, to make changes at any time, without notice, in prices, colors, materials, equipment, specifications, models and availability. Specifications, dimensions, measurements, ratings and other numbers in this catalog and other printed materials provided at the dealership or affixed to vehicles are approximates based upon design and engineering drawings and prototypes and laboratory tests. Your vehicle may differ due to variations in manufacture and equipment. Since some information may have been updated since the time of printing, please check with your GMC dealer for complete details. GMC reserves the right to lengthen or shorten the model year for any product for any reason, or to start and end model years at different times.

FLEET ORDERS Some standard content may be deleted with fleet orders. See dealer for details.

ENGINES GMC products are equipped with engines produced by GM Powertrain or other suppliers to GM worldwide. The engines in GMC products may also be used in other GM makes and models.

GMC.COM See more of Yukon on our Web site: gmc.com/yukon. More photos and information; hot links to related subjects; convenient dealer locator; pricing guide, spec out your own vehicle. Or call 1-800-GMC-8782.

AN IMPORTANT NOTE ABOUT ALTERATIONS AND WARRANTIES Installations or alterations to the original equipment vehicle (or chassis) as distributed by General Motors are not covered by the General Motors New-Vehicle Limited Warranty. The special body company, assembler, equipment installer or upfitter is solely responsible for warranties on the body or equipment and any alterations (or any effect of the alterations) to any of the parts, components, systems or assemblies installed by GM. General Motors is not responsible for the safety or quality of design features, materials or workmanship of any alterations by such suppliers.

NEW-VEHICLE LIMITED WARRANTY All GMC light-duty vehicles come with a fully transferable, no-deductible 5-year/100,000-mile (whichever comes first) Powertrain Limited Warranty. GM vehicles registered in the U.S.A. are also covered for 3 years or 36,000 miles (whichever comes first). Coverage includes tires and towing to your nearest GMC dealership. Repairs will be made to correct any vehicle defect and most warranty repairs will be made at no charge. In addition, rust-through corrosion will be covered for 6 years or 100,000 miles (whichever comes first). See dealer for details.

ASSEMBLY GMC vehicles and their components are assembled or produced by different operating units of General Motors, its subsidiaries or suppliers to GM worldwide. We sometimes find it necessary to produce GMC vehicles with different or differently sourced components than originally scheduled. Since some options may be unavailable when your vehicle is assembled, we suggest that you verify that your vehicle includes the equipment you ordered or, if there are changes, that they are acceptable to you.

GMMOBILITY.COM [1-800-323-9935] GM Mobility offers financial assistance for eligible adaptive equipment to make automotive travel easier for persons with disabilities or special transportation needs. To learn more about special GM Mobility offers, visit gmmobility.com.

GMCARDMEMBERSERVICES.COM Did you know about the family of reward credit cards that can help you get a great deal on a new GM car, light-duty truck, SUV or crossover? With a GM reward card, you accrue earnings on every credit card purchase to use toward the purchase or lease of an eligible new GM vehicle. With three cards to choose from, you're sure to find one that suits you.

¹Requires a subscription, sold separately by SiriusXM after the trial period. SiriusXM Radio service only available in the 48 contiguous United States and the District of Columbia. For more information and to view Customer Agreement, visit siriusxm.com.

©2011 General Motors. All rights reserved. GM, the GM logo, GMC, the slogans, emblems, vehicle model names, vehicle body designs and other marks appearing in this catalog are the trademarks and/or service marks of General Motors, its subsidiaries, affiliates or licensors. Bose, Centerpoint, AudioPilot and SurroundStage are registered trademarks of the Bose Corporation. iPod and iPhone are registered trademarks of Apple, Inc. Facebook is a registered trademark of Facebook, Inc. Twitter is a registered trademark of Twitter, Inc. YouTube is a registered trademark of Google, Inc. SiriusXM is a registered trademark of SiriusXM Satellite Radio. All sculptures ©2006-2011 Robert Lobe.



COLORS

WHITE DIAMOND TRICOAT^{1,2}



STEEL GRAY METALLIC



ONYX BLACK



CRYSTAL RED TINTCOAT²



MOCHA STEEL METALLIC



GOLD MIST METALLIC



QUICKSILVER METALLIC



SUMMIT WHITE



CARBON BLACK METALLIC²



INTERIOR MATERIALS

PREMIUM CLOTH Standard on SLE

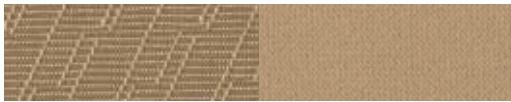

LIGHT TAN



EBONY

LEATHER-APPOINTED Standard on SLT and Hybrid



LIGHT TAN



LIGHT TITANIUM



EBONY

PERFORATED LEATHER-APPOINTED Standard on Denali, Avail on SLT



COCOA/LIGHT CASHMERE



LIGHT TITANIUM³



EBONY

WHEELS

YUKON/WHEELS⁴



N88
17" POLISHED ALUMINUM
STANDARD: SLE AND SLT
1500 MODELS ONLY



RDP
20" POLISHED ALUMINUM
AVAILABLE: SLE AND SLT
1500 MODELS ONLY



S86
20" CHROME-CLAD
AVAILABLE: SLE AND SLT
1500 MODELS ONLY

YUKON 3/4-TON WHEEL⁴



P25
17" WITH 8 LUGS
MACHINED ALUMINUM
STANDARD: YUKON XL
2500 MODELS ONLY

YUKON DENALI/WHEEL⁴



P41
20" CHROME WHEEL
STANDARD: YUKON DENALI AND
YUKON XL DENALI

YUKON HYBRID/WHEELS⁴



P71
18" POLISHED ALUMINUM
STANDARD AND ONLY AVAILABLE
ON YUKON HYBRID



RVA
22" 8-SPOKE CHROME
STANDARD ON YUKON DENALI HYBRID

All colors are basecoat/clearcoat for high-gloss and durable finish. See dealer for more details on paint and color availability. ¹Available on Yukon, Yukon XL and Denali models only. ²Extra-cost color. ³Not available on Denali. ⁴Use only GM-approved wheel and tire combinations. For approved wheel and tire combinations and other important information, go to gmaccessorieszone.com or see your dealer for details.

